

# FRAMELESS GLASS

GLASS CANOPIES AND BOLTED GLASS ASSEMBLIES



**BM**ARCHITECTURAL

# GLASS CANOPY SYSTEMS

## Neo Light System for residential applications

Dimensions (mm)	
Max Width (W)	1500
Max Depth (D)	1050

Recommended glass: 13.5mm for max sizes.

PA max = 1000; PB max = 800; PF max = 250.

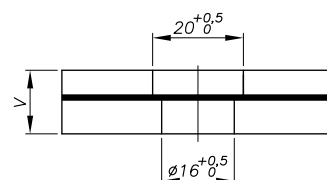
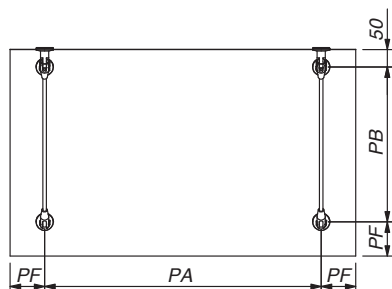
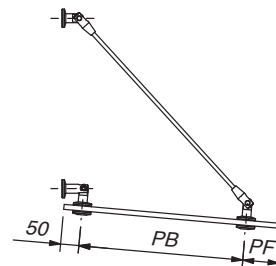
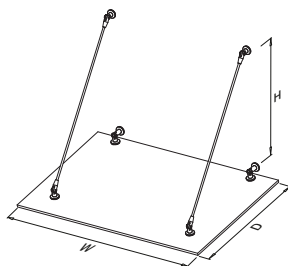

## Neo Strong System for residential applications

Dimensions (mm)	
Max Width (W)	3400
Max Depth (D)	2000

Recommended glass: 25.5mm for max sizes.

PA max = 1000 (4 points)/1300 (6 points)  
PB max = 1500; PF max = 400

For single tension rods (larger sizes are available on request.)

Please call for recommended glass thicknesses on smaller sizes.

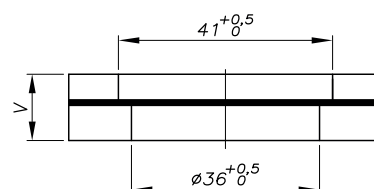
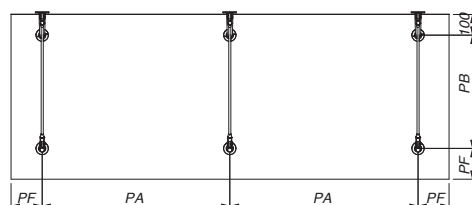
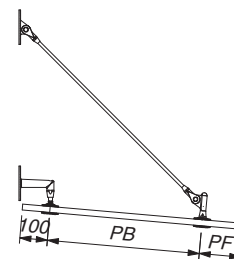
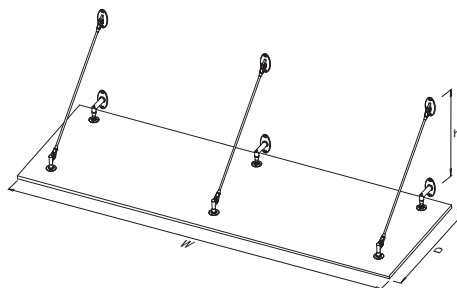

## Neo Plaza System for commercial applications

Dimensions (mm)	
Max Width (W1)	2396
Max Width (W2)	2092
Max Depth (b)	1500

Recommended glass: 25.5mm for max sizes.

PA max = 1900 (4 points)  
PB max = 1500 (4 points); PF max = 400

For single tension rods (larger sizes are available on request.)

Please call for recommended glass thicknesses on smaller sizes.

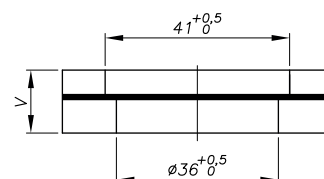
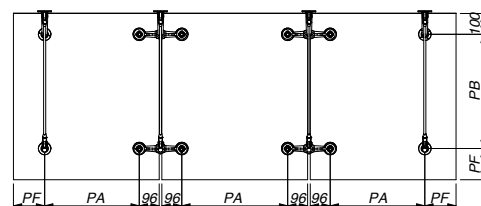
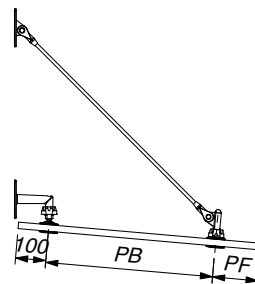
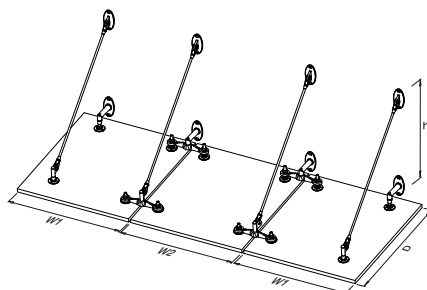

## Silicone Gasket

VEA4235

Article	Length M
VEA4235	25

Semi-opaque, clear silicone.

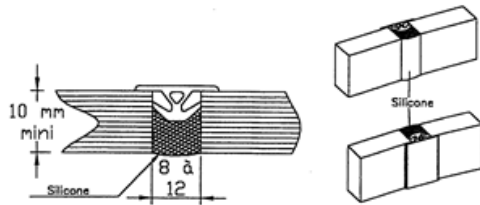

## Articulated Bolts

R1003

Article	Glass mm
R1003	up to 25.5

316 Stainless Steel.  
Tested to EN standards.

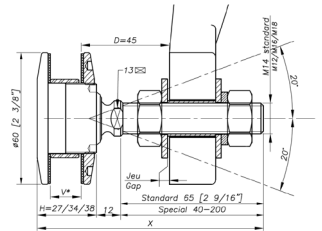
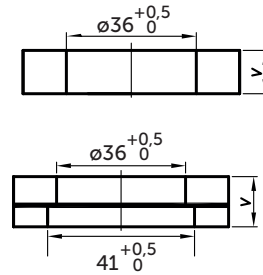

## Fix Bolts

V2005

Article	Glass mm
V2005	up to 25.5

316 Stainless Steel.  
Tested to EN standards.

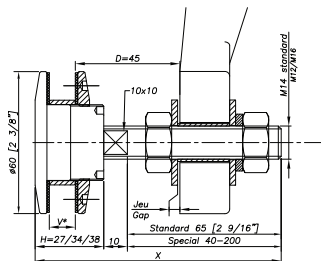
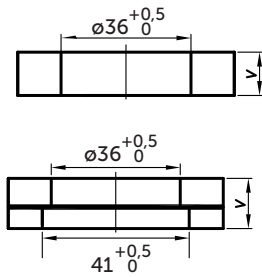

## Tension Rods

Article	Size
Tension Rods	M4 - M24

316 Stainless Steel.  
Tested to EN standards.  
Cold drawn with rolled threading.  
Electro polished fork.  
Coupler, end bolt & repartition disc satin finish.

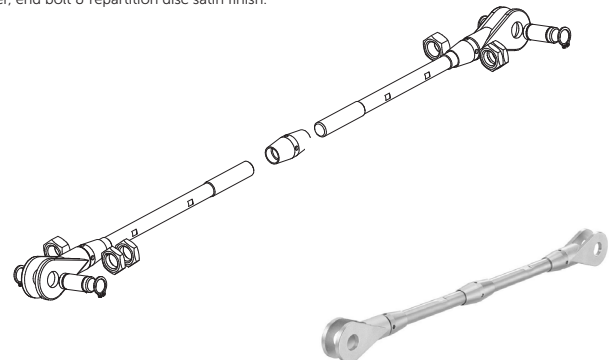

## Adjustable Pin Spanner

Article	Size
09758 1160	-



## Spider

Article	Glass mm
3001-Evo	up to 25.5

Glass mm  
 up to 25.5

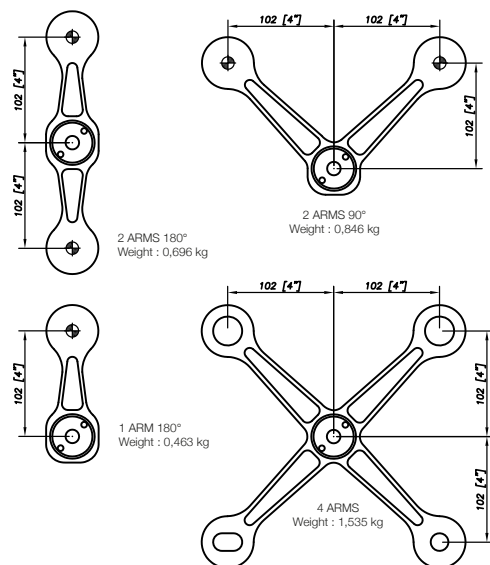

Article	Glass mm	
VP2031C	10-26	Single
VP2032C	10-26	Double

## V2003

Article	Glass mm
V2003	up to 25.5

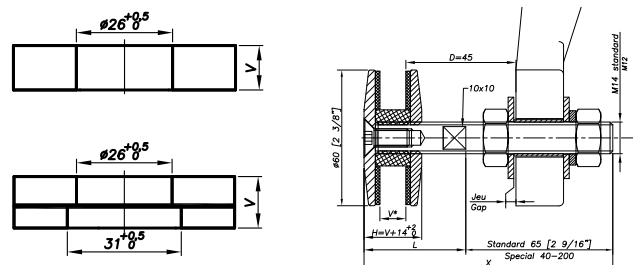

# BMARCHITECTURAL

## SPECIALISTS IN ARCHITECTURAL SYSTEMS

From homes to workplaces and beyond, we help create inspiring and safe spaces where people thrive.

Our expertise areas include:

- Residential, commercial and anti-terror **Glass Balustrade**
- Canopies, partitions and structural walls of **Frameless Glass**
- Fire-rated, security, slimline and thermally-insulated **Steel Glazing**
- **Class A Fire-Rated Balcony Systems** for safer high-rise living
- Composite and recycled plastic products for transforming **Outdoor Spaces**

Our architectural systems enhance the natural light, feeling of space, views, safety and visual appeal of a property. They also enable design professionals and building owners to meet fall protection, thermal, fire and security regulations with ease.

Contact us to discuss your requirements. We supply new-build and renovation projects, large and small, throughout the UK and Ireland.

**T:** 0114 254 3226

**E:** [sales@bmarchitectural.com](mailto:sales@bmarchitectural.com)

**W:** [www.bmarchitectural.com](http://www.bmarchitectural.com)

A BARCLAY & MATHIESON LTD COMPANY

**BMGROUP**

May 2025

**BMSTEEL**



**ANGUS F GUNN LTD**



**BMDISTRIBUTION**